



MagicMoon Automatic
Dispenser

ASD-0003

Installation Manual



Quality Guarantee

*Thank you for choosing the automatic faucet soap dispenser. Please read the instruction carefully before installation. This manual is for your reference only.



Features

- Hands free sensor operation improves hand washing hygiene.
- Easy installation and low-cost maintenance
- Modular one-piece construction with chrome-plated cast brass spout and black throat plate
- Available with hardwired or battery power

Specifications

Power	6V (4 x Alkaline D batteries)
Sensing Range	5 – 15 cm
Foam Vol per Drop	4 – 25 ml (4 ml factory default setting)
Soap Bottle Volume	1500 ml
Ambient Temperature	1 – 55 °C



Before Installation

- Locate position of soap dispenser.
- Ensure that soap dispenser does not interfere with anything above or below the lavatory/counter top area
- Pay special attention so that the sensor surface is not flawed or scratched during the installation process.
- Before installing on the wall, check that no other piping and wiring is running behind hole locations. Wall should be sufficiently reinforced or risk failure due to foam tank case unit falling.
- Do not place other devices that use an inverter or infrared sensor near the faucet, as this may cause the faucet to malfunction.



Tools You will Need

- Adjustable wrench
- Power drill with 25 – 30 mm counter top drill bit
- Phillips screwdriver
- Utility knife
- Hammer
- Ruler/tape measure



Part List

Faucet Body Assembly

1	Sensor
2	Nozzle assembly
3	Hex screw
4	Spout
5	O Ring
6	Tapered washer
7	Nut
8	Tube clip
9	Clear tubing
10	Brass shank
11	Male sensor cable

Control Box Assembly

1	Sensor cable female
2	Control box cover
3	Control box base
4	Push button
5	Hose clip
6	Power cable
7	Fixed frame
8	Suction tube
9	Bottle cap
10	Soap bottle



Part List Diagram

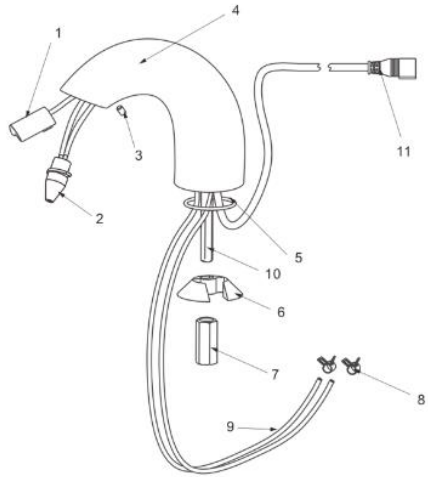
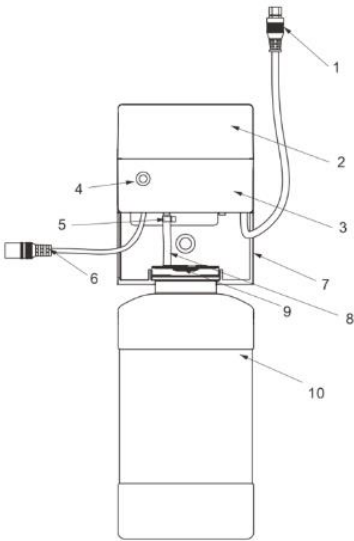



Construction / Installation Diagram

1. Faucet Soap Assembly

- i. Soap Dispenser oftentimes can be mounted in the left or right hole of a 100 mm or 200 mm center-set sink. The ability to do this is contingent upon the width of the faucet spout and accessibility to the unit on the underside of the sink (the Motor and Soap Bottle cannot interfere with the water or drain lines). When such interference above or below the sink occurs, the Soap Dispenser must be installed through the countertop to the side of the sink as shown in figure 1.
- ii. Drill a 25 – 30 mm hole into the counter.
- iii. Slide the plastic gasket onto the brass shank making certain that the hole in gasket is positioned over the washer in the base of the spout.
- iv. Guide the brass shank, tubes and the sensor cable through the hole in the counter.



- v. Position spout to direct soap into the sink
- vi. Screw the flange nut onto the shank and tighten.

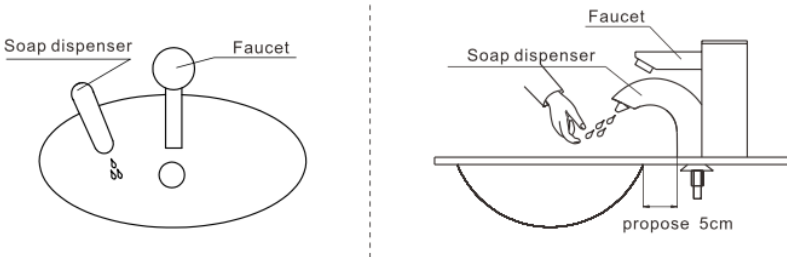

2. Control Box Assembly (Including Battery Box)

- i. Determine a temporary position for mounting the foam tank & battery case units.
- ii. Make sure foam tank unit is within reach of the liquid soap and air tube from the foam soap dispenser.
- iii. Use the mounting grey plastic bracket as a guide, mark where holes need to be drilled. Important: Make sure bracket and foam tank case unit is mounted level. Repeat for battery case unit.



- iv. When installing onto a concrete wall, drill holes 30 mm deep using a 6 mm masonry drill bit. Insert wall anchors into the holes and mount the dispenser using screws.
 - v. When installing onto a wood wall, drill holes using a 3 mm drill bit and attach the dispenser bracket using screws provided.
 - vi. Remove the battery case cover and install 4 D size batteries. Assemble back the cover and tighten the cover using the four supplied Philips screws. Guide the male battery box cable through the bottom opening and place the case.
3. Connect Foam & Air Tubes
- Connect the foam soap tube and air tube from the foam soap dispenser into the soap tube fitting and air tube fitting found on top of the foam tank case unit, respectively.
- i. Check soap tube tags and align with correct fittings as indicated on the fitting's connection label.
 - ii. Cut the soap tube and the air tube at suitable lengths. Ends should be cut at right angles and tubes should be



free of kinks and bends
when connected.

- iii. Insert soap tube and air tube
into respective fittings and
secure with tube clamps.

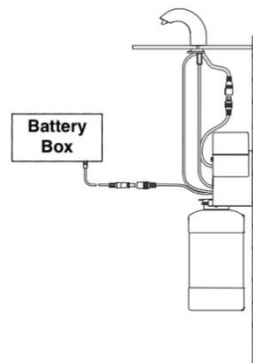
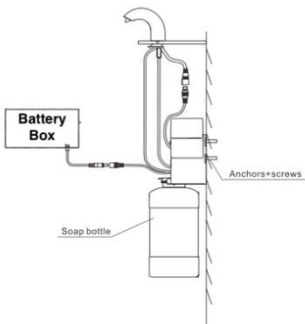
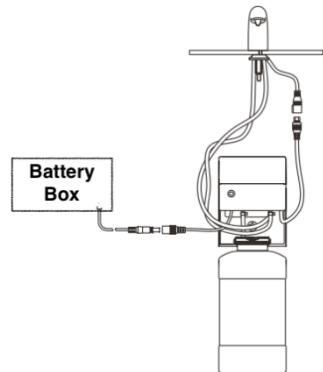
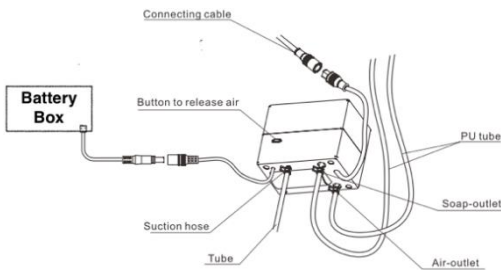



Fill / Refill Soap

1. Lift the soap bottle and horizontally pullout the bottle.
2. Remove the plastic bottle cap.
3. Fill the bottle with 2 parts water & one-part soap concentrate. Avoid overfilling the bottle.
4. Return the bottle back into the case unit (fixture frame).
5. Push the green button on the controller to release trapped air & prepared the dispenser for use.



Fill / Refill Soap Diagram

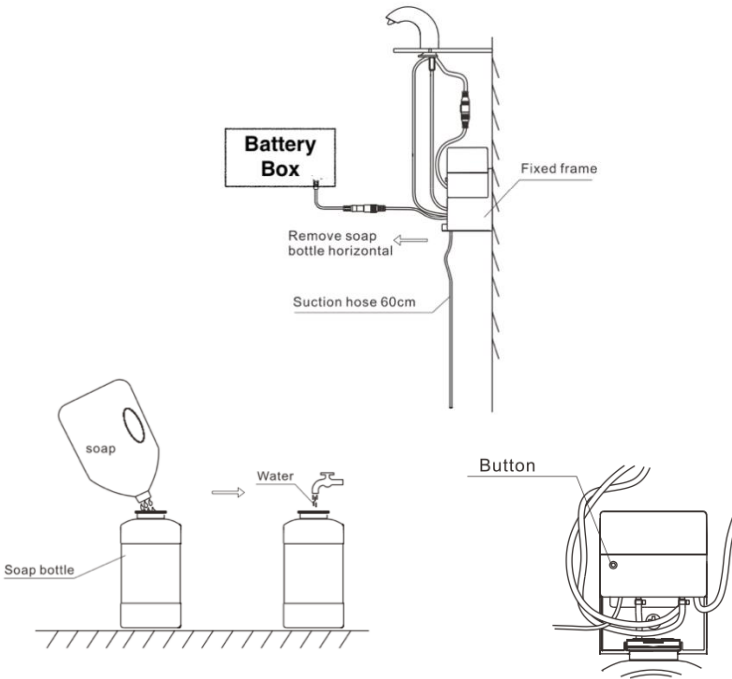



Operations

As the user's hands enter the beam's effective range, the beam is reflected back into the sensor receiver and activates the solenoid valve allowing a single soap application to flow from the spout.

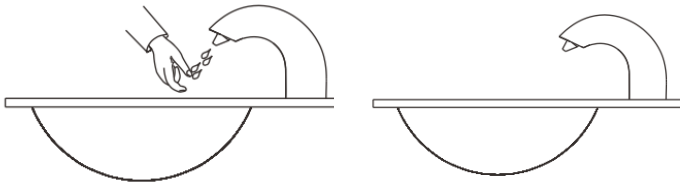



Soap Volume Adjustment

No adjustments are required for most settings. Factory default soap volume is 4 ml. The factory setting should be satisfactory for most installations.

To adjust the volume, aim the remote control at sensor eye. Press the plus “Time +” to increase the soap volume and “Time – “to reduce the volume. The LED will flash three times when the maximum or minimum dispense volume has been reached.

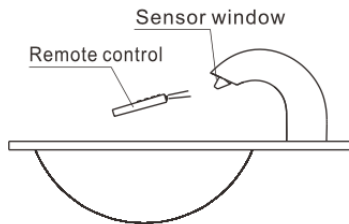



Soap Dispensing Range Adjustments

To adjust the dispensing range:

1. On the remote press the auto adjust button.
2. Place hand at the desired distance. The LED will flash for 1 sec then stays on for 3 secs to confirm setting.

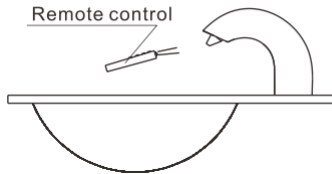



Battery Replacement

1. Disconnect the power cables.
2. Remove the black battery holder from the case unit
3. Using a Philips screw driver, remove the two Philips screws, plastic cover and the four D size batteries.
4. Replace with 4 new batteries, place back the cover and tighten the assembly.
5. Place back holder onto the case unit and connect the power cables.



Troubleshooting

1. Unit does not operate
 - i. Check battery power cables are connected. Connect power cables.
2. Soap does not dispense
 - i. Soap bottle needs refill. Refill 2:1 water & soap.
 - ii. Check soap dispensing nozzle for clog. Clean nozzle with soft cloth.
3. Liquid soap is not in foam state
 - i. Soap bottle needs refill. Refill 2:1 water & soap.



Care & Cleaning

DO NOT USE abrasive or chemical cleaners (including chlorine bleach) to clean faucet that may dull the luster and attack the chrome or special decorative finishes. Use ONLY mild soap and water, then wipe dry with clean cloth or towel. While cleaning the bathroom tile, protect the dispenser from any splattering of cleaner. Acids and cleaning fluids will discolor or remove chrome plating.



Resources



For Installation guides, visit our resource page through the QR code

Alternatively, you can visit our resource page at <https://faucetscanada.ca/resource/s/>



To view more products from Faucets Canada, visit our shop page through the QR code.

Alternatively, you can visit our shop page at <https://faucetscanada.ca/shop/>

Warranty Information



For information on product warranty, visit our resource page through the QR code.

Alternatively, you can visit our warranty claims page at <https://faucetscanada.ca/warranty-claim/>



About us

Here at FCI, our main goal is to break the eco-innovation boundary and provide customers with fixtures that save water and deliver reliable sources of sanitation every time.

As Canada's favourite automatic faucet brand, we are proud to say we deliver quality touchless fixtures that perform beyond expectations and exceed design standards.

To learn more about Faucets Canada, please visit our website at FaucetsCanada.ca